



GIMA

SFIGMOMANOMETRI DALLAS
SPHYGMOMANOMETERS DALLAS - TENSIOMETRES DALLAS
ESFIGMOMANOMETROS DALLAS - BLUTDRUCKMESSGERÄTE
DALLAS - ESFIGMOMANOMETROS DALLAS
ΣΦΥΓΜΟΜΑΝΟΜΕΤΡΑ DALLAS

MANUALE D'USO E MANUTENZIONE
USE AND MAINTENANCE BOOK
INSTRUCTIONS DE FONCTIONNEMENT ET ENTRETIEN
BETRIEBS UND WARTUNGS ANWEISUNGEN
MANUAL DE USO Y MANTENIMIENTO
MANUAL DE USO E MANUTENÇÃO
Οδηγίες χρήσεως

ATTENZIONE: Gli operatori devono leggere e capire completamente questo manuale prima di utilizzare il prodotto.

ATTENTION: The operators must carefully read and completely understand the present manual before using the product.

AVIS: Les opérateurs doivent lire et bien comprendre ce manuel avant d'utiliser le produit.

ACHTUNG: Die Bediener müssen vorher dieses Handbuch gelesen und verstanden haben, bevor sie das Produkt benutzen.

ATENCIÓN: Los operadores tienen que leer y entender completamente este manual antes de utilizar el producto.

ATENÇÃO: Os operadores devem ler e compreender completamente este manual antes de usar o produto

ΠΡΟΣΟΧΗ: Οι χρήστες πρέπει να διαβάσουν και να καταλάβουν εντελώς αυτό το εγχειρίδιο πριν χρησιμοποιήσουν το προϊόν

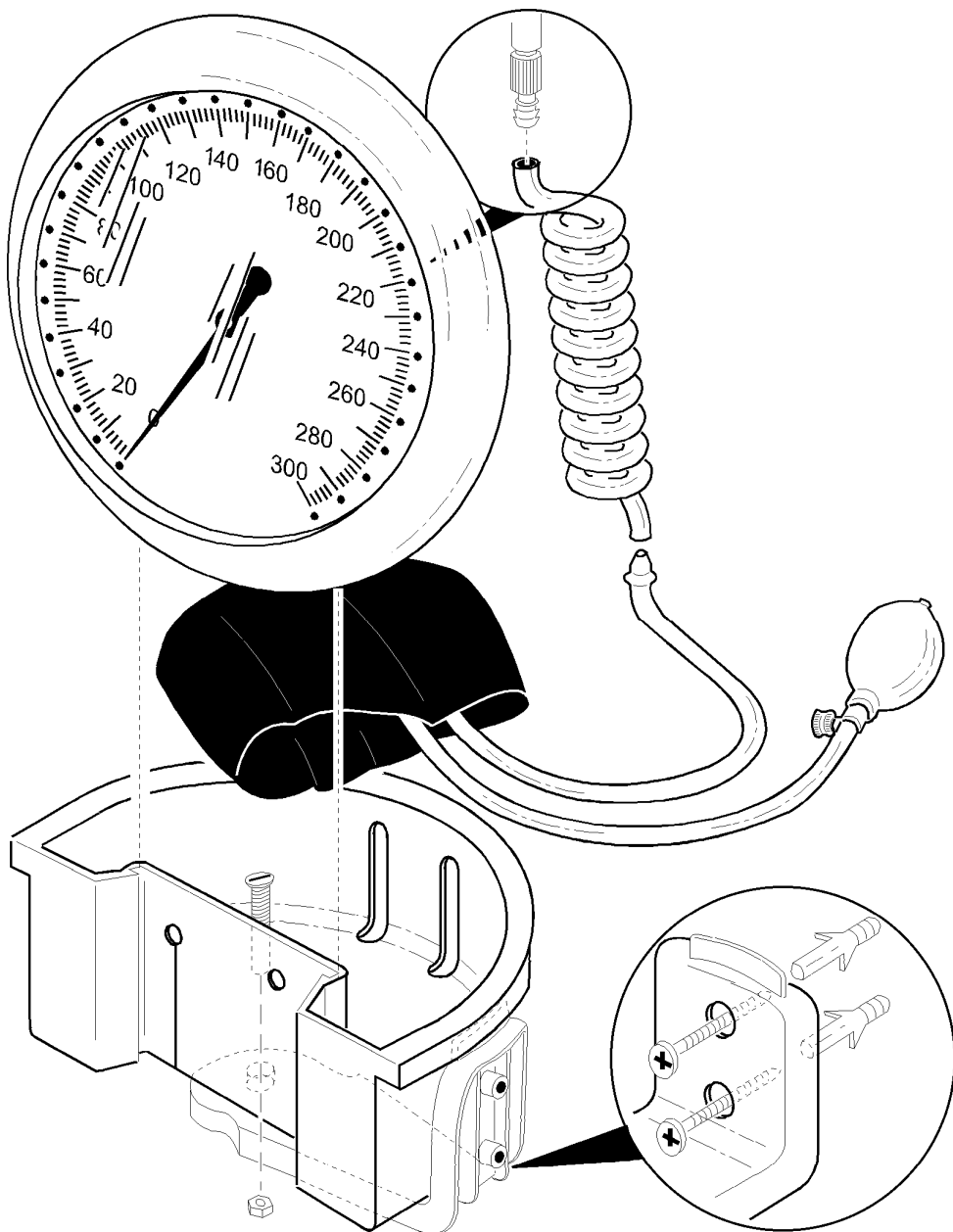

0476

**Cod. 32749**



Cod. 32748

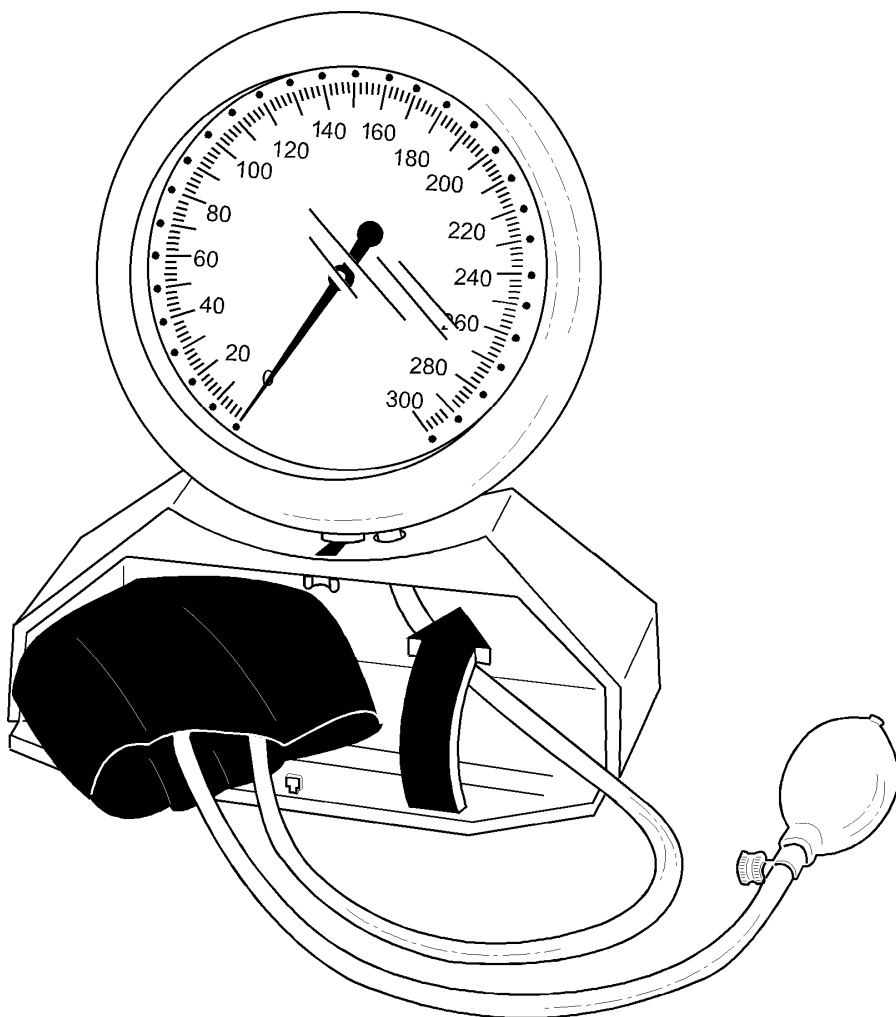

CARATTERISTICHE



Desideriamo ringraziarVi per avere acquistato uno sfigmomanometro di precisione GIMA. Tutti gli sfigmomanometri GIMA sono prodotti con materiali di alta qualità e garantiscono, se mantenuti in perfetta efficienza attraverso periodici controlli di taratura, una totale affidabilità e precisione, anche a distanza di anni.

La nostra linea di sfigmomanometri offre infatti gli stessi standard qualitativi sia per i modelli professionali che per quelli domiciliari. Lo sfigmomanometro da Voi acquistato è conforme alla direttiva 93/42/CEE.



Diastole = Valore minimo di pressione sanguigna, presente quando il muscolo cardiaco è in fase di espansione e torna a riempirsi di sangue.

4) Aprire ora completamente la valvola di sfiatamento, affinché l'aria fuoriesca subito dal bracciale. La misurazione della pressione sanguigna è così terminata.

MANUTENZIONE

1. Manometro e pera

Pulizia: Il manometro e la pera si possono strofinare con un panno umido. Non è necessaria la sterilizzazione, poiché le parti non entrano in contatto diretto con il corpo del paziente.

2. Bracciali

Pulizia: Dopo aver estratto il polmone, le fodere si possono strofinare con un panno umido oppure, si possono lavare con sapone in acqua fredda. Applicando questo secondo metodo, risciacquare i bracciali con acqua pulita e lasciarli asciugare all'aria. I bracciali in nylon non vanno stirati.

Il polmone e i tubi si possono strofinare con un panno umido di cotone.

GARANZIA

La garanzia è valida per il tempo di 12 mesi dalla data di fornitura GIMA.

Durante il periodo di validità della garanzia si provvederà alla riparazione e/o sostituzione gratuita di tutte le parti difettose per cause di fabbricazione ben accertate, con esclusione delle spese di mano d'opera, trasferta, spese di trasporto, di imballaggio, ecc. Sono quindi esclusi dalla garanzia i componenti soggetti ad usura come le parti in caucciù o PVC.

Nessun risarcimento potrà essere richiesto per il fermo dell'apparecchiatura.

Inoltre la sostituzione o riparazione effettuata durante il periodo della garanzia non hanno l'effetto di prolungare la durata della garanzia.



La garanzia non è valida in caso di: riparazione effettuata da personale non autorizzato o con pezzi di ricambio non omologati da GIMA, avarie o vizi causati da negligenza, botte, uso anormale dell'apparecchio o errori di installazione.

La garanzia decade se il numero di matricola risulti asportato, cancellato o alterato.

Gli apparecchi ritenuti difettosi devono essere resi solo e soltanto al rivenditore presso il quale è avvenuto l'acquisto. Spedizioni a noi inviate direttamente verranno respinte.



FEATURES

We would like to thank you for having purchased a precision GIMA sphygmomanometer.

All GIMA sphygmomanometers are manufactured with high quality materials and, when maintained at perfect operating efficiency through regular calibration checks, ensure complete reliability and precision, even after several years of use.

Our line of sphygmomanometers offers the same quality standards for both professional and home models.

The sphygmomanometer you have purchased complies with EEC directive 93/42/CEE.

PRESCRIPTIONS



It must be noted that self-measuring instruments are not a substitute for regular medical checkups, and that only your doctor can accurately analyze these measurements.

Arterial pressure is highly influenced by one's nervous tension and physical fatigue. It is therefore recommended that you **perform the measurement under conditions of both physical and mental**



relaxation, while in a sitting or supine position and, where possible, always at the same time of day, far from meal times.

Remember: do **not move while measuring your pressure** and do not wear clothing that covers your arm and could limit blood circulation.

Pressure varies during the day: it is lower in the morning and higher in the evening; it is also lower in the summer and higher in the winter.

INSTALLATION

After opening the packages, first of all it is necessary to check all pieces and parts composing the product. Check that they are all present and in perfect conditions.

Apply the armband to your bare left arm, 2-3 cm. above your elbow joint, and then prop up your forearm, keeping it at heart level.

Velcro armband: Close the armband using the Velcro strap.

If not specifically indicated, all GIMA sphygmomanometers are equipped with armbands for adults; upon request, we can provide armbands for the obese, for use on the thigh and for children, ranging from premature babies up to 14-year-olds.

Position the earpiece of the stethoscope (preferably our DUCA model) on the artery, under your arm.

FUNCTIONING

1) After applying the armband, use the bulb to pump up to approximately 20 mmHg beyond the level of individual systolic pressure: in other words, until the brachial artery is blocked (maximum level). It is essential that the person being measured remains seated and calm, and that his/her **forearm is resting at heart level**, with the inside part facing up.

2) To measure blood pressure, turn the release/deflation screw on the bulb, unscrewing it slowly in a counter-clockwise direction. The ideal deflation speed is around **2-3 mmHg/sec**.

Visually check deflation speed: on the scale, the indicator must move at a speed of between 1 and 1.5 gradations per second.

The models featuring automatic deflation of the gauge, which automatically regulates deflation speed at 2-3 mmHg/sec. Simply press the valve up to the first pressure point.

3) Due to the gradual decompression, your blood starts to run through the brachial artery again, which in turn causes an initial pulsation, that is clearly perceived by the phonendoscope: the pressure indicated on the gauge needle at the exact moment this first beat is recorded is referred to as the **“systolic or maximum pressure”**.

Systole = maximum pressure level when the heart contracts and blood is pushed into the blood vessels. As you proceed with decompression, the pulsations gradually decrease until they suddenly disappear or become so low as to be imperceptible.

The pressure indicated by the gauge needle at the moment the pulsations disappear is referred to as the **“diastolic or minimum pressure”**.

Diastole: minimum blood pressure level when the heart muscle is expanding and refilling with blood.

4) Now completely open the release valve until air begins to come out of the armband. Blood pressure measurement is now completed.

MAINTENANCE

1. Gauge and bulb

Cleaning: The gauge and bulb can be wiped with a damp cloth. Sterilization is not necessary, as the parts do not come into direct contact with the patient's body.

2. Armbands

Cleaning: After removing the plenum chamber, the liners can be wiped with a damp cloth, or you can wash them with soap and cold water. If you use this second method, rinse the armbands with clean



water and leave them to air dry. Nylon armbands must not be ironed.
The plenum chamber and tubes can be wiped with a damp cotton cloth.

GUARANTEE

The product has a 12 month warranty, valid from the date it is delivered by GIMA.
During the guarantee period free repair and/or replacement of any defective parts due to faulty manufacture will be given, labour, postal, transport and packaging charges etc. are not included. The guarantee therefore excludes components subject to wear and tear such as parts in rubber or PVC. No compensation will be given for loss of use of the appliance.
Furthermore replacement or repairs effected during the guarantee period do not lengthen the duration of the guarantee.



This guarantee is void in the event of: repairs effected by unauthorised persons or with spare parts not approved by GIMA, damage or defects caused by negligence, blows, abnormal use of the appliance or faulty installation.

The guarantee will be invalidated if the registration number has been removed, cancelled or altered. Faulty appliances must be returned only to the retailer where the item was bought. Any item dispatched directly to us will be refused.



CARACTERISTIQUES

Nous désirons avant tout vous remercier d'avoir acheté un tensiomètre de précision GIMA.
Tous les tensiomètres GIMA sont produits avec des matériaux de qualité supérieure et garantissent - à la condition de les maintenir en parfaite efficacité à travers des contrôles périodiques d'étalonnage - une fiabilité et une précision totales, même après des années.
Notre ligne de tensiomètres offre les mêmes niveaux de qualité. Qu'il s'agisse de modèles professionnels ou de modèles à utiliser soi-même. Le tensiomètre que vous avez acheté est conforme à la directive 93/42/CEE.

PRESCRIPTION



Il y a lieu de souligner qu'un autotensiomètre ne remplace nullement des visites régulières chez son médecin et que seul ce dernier est capable d'analyser exactement les valeurs mesurées.

La pression artérielle est considérablement influencée par des conditions de tension nerveuse ou de fatigue physique. Il est donc recommandé de **procéder à la mesure dans des conditions de repos tant physique que mental**, allongée sur le dos, dans la mesure du possible, toujours à la même heure du jour, loin des repas.

Il est également recommandé de **ne pas remuer au cours de la mesure** et de ne pas porter des vêtements qui comprimeraient le bras et pourraient ainsi entraver la circulation du sang.

La tension varie au cours de la journée. Elle est plus basse le matin et plus haute le soir. Plus basse l'été et plus haute l'hiver.

MONTAGE

La première opération à faire après avoir ouvert les emballages, est un contrôle général des pièces et des parties qui composent le produit; vérifier que soient présents tous les composants nécessaires et qu'ils soient en conditions parfaites.

Appuyez le brassard sur le bras gauche à nu, 2-3 cm au-dessus du pli du coude. Appuyez votre avant-bras en le tenant à la hauteur du cœur.

Brassard velcro: fermer le brassard avec la fermeture prévue.